

5.960-851 04/03/2005041

 **KÄRCHER**

**K 1405**

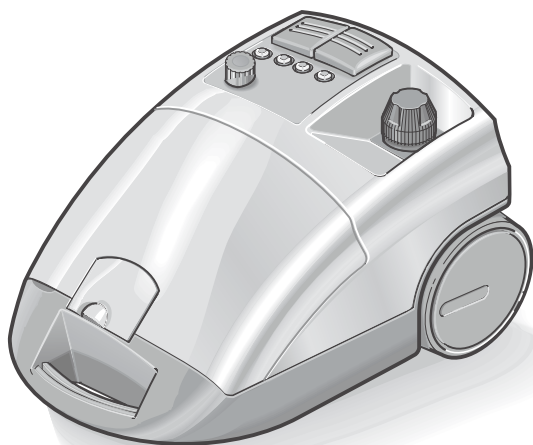

## Contents

1. Equipment features .....	2
2. SAFETY INSTRUCTIONS .....	3
3. Getting started .....	6
4. Information on usage .....	8
5. How to use the accessories .....	8
6. Maintenance .....	11
7. Safety devices .....	12
8. General information .....	12
9. Accessories and replacement parts .....	13
10. Technical specifications .....	14
11. Spare Parts List .....	15

## CAUTION

**DO NOT USE THIS PRODUCT ON DELICATE FABRICS INCLUDING DRALON, ANY ITEMS PROTECTED BY SCOTCH GUARD OR ANY SIMILAR SUBSTANCE.**

**BEFORE CLEANING UPHOLSTERY TEST ON A SECTION NOT NORMALLY VISIBLE.**

# 1. Equipment features

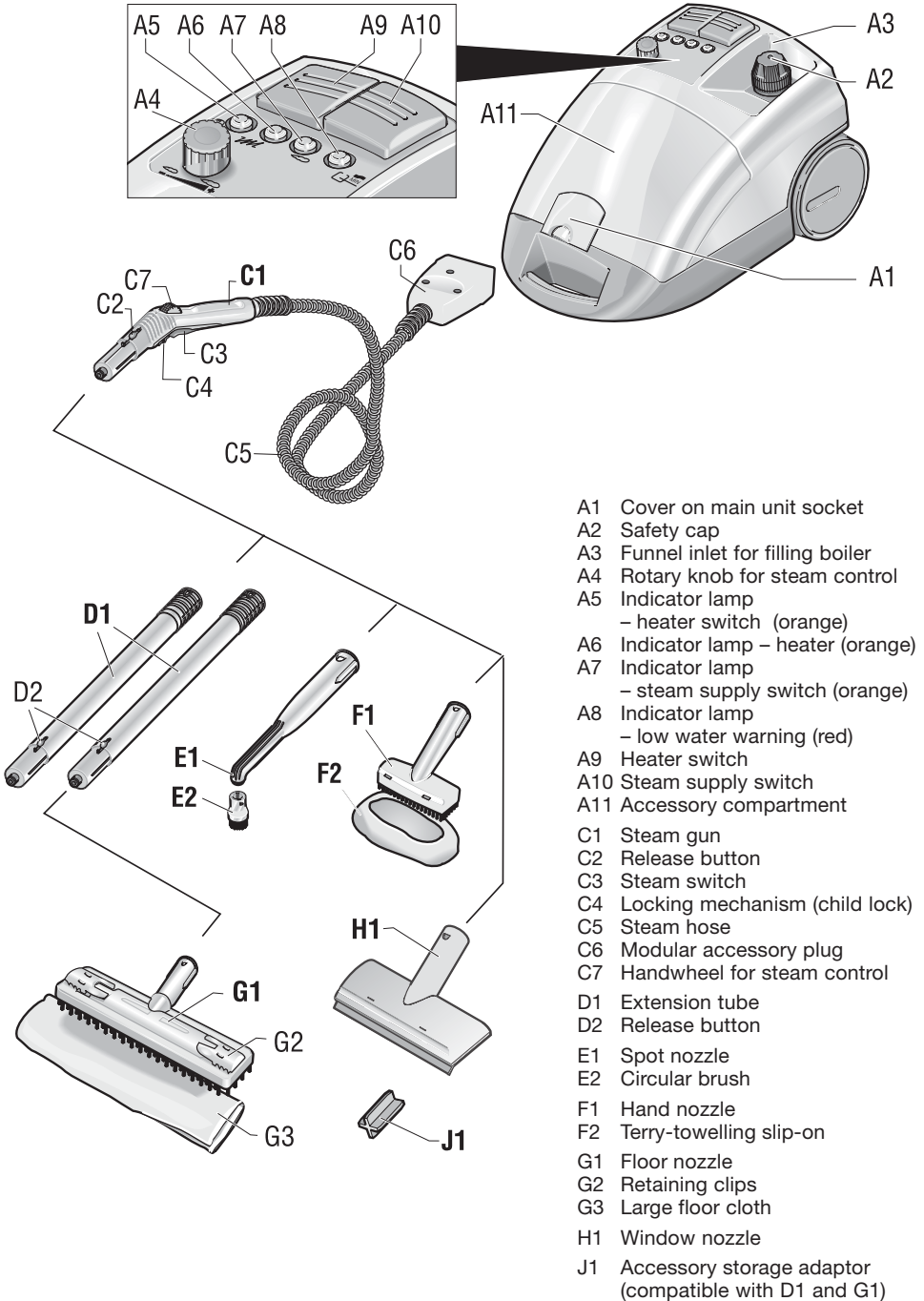

- A1 Cover on main unit socket
- A2 Safety cap
- A3 Funnel inlet for filling boiler
- A4 Rotary knob for steam control
- A5 Indicator lamp  
– heater switch (orange)
- A6 Indicator lamp – heater (orange)
- A7 Indicator lamp  
– steam supply switch (orange)
- A8 Indicator lamp  
– low water warning (red)
- A9 Heater switch
- A10 Steam supply switch
- A11 Accessory compartment
- C1 Steam gun
- C2 Release button
- C3 Steam switch
- C4 Locking mechanism (child lock)
- C5 Steam hose
- C6 Modular accessory plug
- C7 Handwheel for steam control
- D1 Extension tube
- D2 Release button
- E1 Spot nozzle
- E2 Circular brush
- F1 Hand nozzle
- F2 Terry-towelling slip-on
- G1 Floor nozzle
- G2 Retaining clips
- G3 Large floor cloth
- H1 Window nozzle
- J1 Accessory storage adaptor  
(compatible with D1 and G1)

## 2. SAFETY INSTRUCTIONS

**PLEASE READ THIS LEAFLET CAREFULLY BEFORE OPERATING YOUR UNIT.**



### **IMPORTANT SAFETY NOTES**

#### **ELECTRICAL CONNECTION AND SUPPLY**

#### **WARNING - THIS APPLIANCE MUST BE EARTHED**

*The supply voltage must be the same as that shown on the rating plate.*

**Important :** if a new plug is to be fitted

- the wires in the mains lead are coloured in accordance with the following code : Green and yellow - Earth / Blue - Neutral / Brown - Live
- as the colours of the wires in the mains lead of this appliance may not correspond with the markings identifying the terminals in your plug, proceed as follows :
- the wire which is marked with the letter „E“ or by the earth symbol  or coloured green and yellow
- the wire which is coloured blue must be connected to the terminal which is marked with the letter „N“ or coloured black
- the wire which is coloured brown must be connected to the terminal which is marked with the letter „L“ or coloured red
- each wire must be properly connected to the appropriate terminal pin of a suitable plug and the outer sheath of the mains lead securely retained by the cable clamp arrangement of the plug
- If a 13 Amp BS 1363 plug is used it should be fitted with a 13 Amp fuse

*If any doubt, contact your nearest Karcher Authorised Agent or Qualified Electrician*

## 2. SAFETY INSTRUCTIONS

### Steam Cleaner

- If you notice any transport damage while unpacking the unit, notify your dealer immediately.
- The warning and information decals attached to the unit feature provide important details for safe operation.
- In addition to the information provided in the Operating Instructions, the general safety regulations and accident prevention ordinances imposed by official authorities must be observed.



### Electrical Connection

- Connect the unit only to properly grounded mains receptacles supplying the voltage indicated on the rating plate.
- Devices certified in compliance with Protection Class I must be operated on properly earthed power sources.
- In high-humidity environments, such as bath installations, the unit may be operated only in conjunction with an approved protective ground-fault circuit interruptor. Please obtain the advice of an electrical specialist.
- The unit must be operated with the power supply cord or cable as specified by the manufacturer. No substitutions are permitted. Observe the maintenance instructions. Refer to the Operating Instructions for part number and original equipment designation.
- Never touch the power plug with wet hands.
- The power cord and/or extension cord must not be subjected to of mechanical damage by vehicle tyres, or to lateral or longitudinal distress (squeezing, pinching or pulling).
- The extension cord must have the cross-section specified in the Operating Instructions, and must be spray-water protected. The cable coupling must not be placed in water.
- When replacing couplings on power or extension cords, the splash protection and mechanical strength must be maintained. Observe the maintenance instructions.

### Operating Specifics

- Prior to each use, the unit and its attachments must be inspected for proper condition and operational safety. If the unit is found to be in unsatisfactory or unsafe condition, its use is prohibited.
- Please check especially the safety cap and the electrical power connection.
- The steam hose must be free of damage (scalding hazard!). A damaged steam hose must be replaced without delay.
- Only hoses and connecting elements approved by the manufacturer may be used.
- Refer to the Operating Instructions for order number and original equipment designation.
- Never fill the boiler with solvent-bearing liquids or undiluted acids! This particularly includes cleaning agents, petrol or paint thinner. **EXPLOSION HAZARD!** Also, do not use acetone, undiluted acids and solvents, because they attack the materials of which the unit is constructed.
- In the event that the unit is used at petrol stations and in other hazardous areas, the appropriate safety regulations must be observed. Operation of the unit in explosive environments is prohibited.
- The unit must be placed securely on a firm surface.
- During operation, the steam control switch must not be wedged open.
- Use extreme caution when filling water into the boiler while it is still hot. Sudden steam pressure could expel hot water from the boiler and cause severe scalding injury!

## 2. SAFETY INSTRUCTIONS

### Cleaning of electrical appliances

- When cleaning electrical appliances (including electric cookers), they must be cut off from the mains (switch off circuit breakers or remove the fuse). Before returning them to normal operation, the appliances must be allowed to dry thoroughly.
- Please observe the instructions of the respective appliance manufacturers!
- Steam cleaning is prohibited on all electrical appliances, i.e., hair dryers, electrical heaters, etc. that allow direct steam contact with electrical wiring and switches. The steam could enter into the electrical components and, on condensing, cause an electrical defect.
- Never touch the steam jet with your hand, or direct it at persons or animals (scalding hazard).
- Materials containing asbestos and other items known to contain hazardous substances must not be steam-cleaned.

### Operating the Unit

- The operator may use the unit only as described in the Operating Instructions. He is obligated to observe local conditions and, while working with the unit, take into account the presence of third persons, and especially children.
- The unit may be operated only by persons who have been thoroughly instructed in its use, or who have provided proof of their ability to operate the unit, and who have been expressly charged with operating the unit. The unit may not be operated by children or adolescents.
- The unit must never be without supervision while it is operating.

### Moving the Unit

- The unit must be switched OFF and securely fastened while moving it between locations.

### Maintenance

- Prior to performing cleaning and maintenance procedures, and before replacing parts, the unit must be switched OFF, and the power plug must be disconnected.
- Repair and service procedures may only be performed by authorised customer service depots or by experts who are thoroughly familiar with all applicable safety regulations.

### Accessories and Spare Parts

- Only accessories and spare parts approved by the manufacturer may be used. Original accessory and original spare parts ensure a safe a trouble-free operation of the unit.
- Please use only the original safety cover!

## 3. Getting started

### 3.1 Unpacking the cleaner

While you are unpacking the cleaner, check that all accessories have been included. If any items are missing, please contact your dealer. If you notice any damage that has been caused in transit, please inform your dealer immediately.

Do not dispose of the packaging materials as domestic refuse. They can be recovered for use again. Take the packaging to an official collection point for recycling.

### 3.2 Attaching the accessories

- Firmly insert the modular accessory plug (C6) into the socket (A1) above the handle on the main unit. Both lugs on the plug must lock into the cover for the main unit socket.

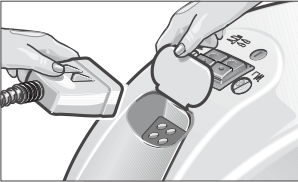

- Attached the required accessory – spot nozzle (E1), hand nozzle (F1) or floor nozzle (G1) – to the steam gun (C1) by pushing the tubular end of the accessory onto the steam gun. Push the accessory onto the steam gun as far as necessary for the release button (C2) on the steam gun to lock into place.

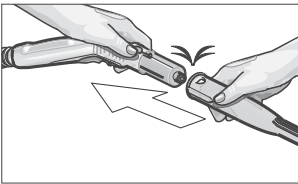

- Use the extension tubes (D1) if required. Attach one or both tubes onto the end of the steam gun. Push the required accessory onto the free end of the extension tube.
- To detach the accessories, press the release button and pull the items apart.

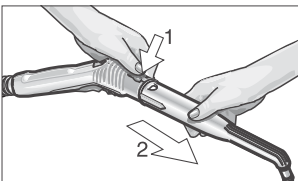

- The circular brush (E2) can be attached to the spot nozzle to obtain better cleaning results. Line up both grooves in the circular brush with the lugs on the spot nozzle and turn the brush clockwise as far as it will go.

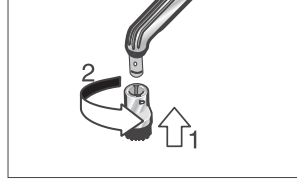

- To detach the circular brush from the spot nozzle, turn the brush anti-clockwise and pull it off the nozzle.

**!** *Hot water can drip out of accessories while you are detaching them. Do not detach accessories while steam is being discharged – danger of scalding!*

### 3.3 Filling up with water

- Unscrew the safety cap (A2) on the main unit.
- Pour a maximum of 2 litres of tap water into the boiler. With the cleaner standing on a horizontal surface, the boiler can be filled up to approx. 2 cm below the edge of the filler neck. Heating-up time can be shortened by using hot water.

**!** *Do not add pour any detergents or other additives into the boiler.*

- Screw the safety cap back onto the cleaner.

### 3.4 Switching the cleaner ON

**!** *Do not switch the cleaner on if there is no water in the boiler, otherwise it could over-heat. As a safety measure, the cleaner's heater switches off automatically and the low-water warning lamp illuminates. In order to be able to use the cleaner again, wait approx. 10 minutes for it to cool down and then fill the boiler with water (see 3.3 "Filling up with water").*

- Plug the cleaner into a mains socket. Switch both the steam supply switch (A10) and the heater switch (A9) to ON. The indicator lamps (A5, A6, A7) should illuminate.

## 3. Getting started

- When the orange lamp for the heater (A6) goes out again, the cleaner is ready for use.

 **When the appliance is switched on, do NOT place in a vertical position.** To prevent the appliance from overheating, a built-in safety device isolates the appliance and all indicator lights switch off. Place the appliance back in its original horizontal position. The indicator lights switch on again and you can continue working.

- Switch off the heater before moving the cleaner.
- When you are ready to start work with the cleaner, you must first release the locking mechanism (child lock (C4)) on the steam gun (C1), otherwise you will not be able to operate the steam switch (C3). Slide the locking mechanism forwards and you will then be able to press the steam switch.

**Note:** Slide the locking mechanism towards the rear to engage the child lock whenever you are not using the steam gun.

- When you press the steam switch, steam is discharged from the nozzle. Begin by pointing the steam gun at a cloth until a steady flow of steam comes out of the nozzle.
- The heater is repeatedly switched on while you are using the cleaner, in order to maintain the pressure inside the boiler. At the same time the orange indicator lamp (A6) illuminates.

### 3.5 Regulating the volume of steam

Rotary knob for steam control (A4)

- You can adjust the steam quantity continuously by turning the rotary knob (A4).

Handwheel for steam control (C7)

- At first, set the rotary knob (A4) to the maximum steam quantity.
- The amount of steam can be regulated according to requirement by adjusting the handwheel (C7) on the steam gun. When the wheel is turned forwards, a large amount of steam is discharged; when it is turned towards the rear, a small amount of steam is discharged.

**Note:** When the handwheel is set for minimum steam, it is possible that steam will continue to

be discharged briefly after the steam switch (C3) has been released, until the pressure in the steam hose has dropped. You can accelerate this process by briefly turning the handwheel (C7) forwards.

### 3.6 Refilling with water

**Note:** When the water in the boiler has been used up, the red low-water warning lamp (A8) will illuminate. The safety cap (A2) cannot be opened while there is any pressure at all in the boiler.

- Turn off the heater switch but leave the steam supply switch on.
- Press the steam switch on the steam gun and hold it pressed until steam is no longer discharged from the nozzle. There will then be no pressure inside the boiler.
- Unscrew the safety cap from the cleaner.

 *If the cleaner has been in continuous use for a long time, the safety cap (A2) may be hot!*

**Caution:** *Never lift the cleaner by the handle unless the safety cap is in place!*

- Pour a maximum of 2 litres of tap water into the boiler.

 *If the boiler is still hot, there is a risk that water will be squirted back while it is being poured into the boiler and cause scalding.*

- Firmly screw the safety cap back onto the cleaner. Turn on the heater switch again. When the heater indicator lamp goes out, the cleaner is ready for use again.

### 3.7 Switching the cleaner OFF

- Switch off both the heater and steam supply switches.
- Unplug the cleaner from the mains.
- Lift up the cover on the main unit socket (A1) and pull out the modular accessory plug (C6).
- Any remaining water can be left inside the cleaner.

## 3. Getting started

### 3.8 Transporting the unit

- If you have been working with the extension tubes (D1) and the floor nozzle (G1), it is quite easy to transport the unit, e.g. up and down stairs.
- Turn the heater OFF with switch (A9), stand the unit upright, and attach the extension tube to the retaining bracket on the underside of the main unit.

**Note:** The extension tube can only be attached if the mains cable has not already been wound round the holder on the main unit.

### 3.9 Storing the unit

- Place the hand nozzle, window nozzle, spot nozzle and other small parts into the accessory compartment (A11).
- Wind the cable around the holder on the base of the main unit. Insert both extension tubes individually into the recesses in the base of the unit. Stick the floor nozzle with the accessory storage adaptor (J1) on a extension tube.
- Ensure that the brushes are allowed to cool down without the bristles becoming deformed in the process.

**Important:** If you wish to leave the unused water in the boiler until the next use, do **not** store the unit in the vertical position (safety cap may become stuck due to furring). If you wish to store the unit for a longer period of time or in the vertical position, please drain the water off completely.

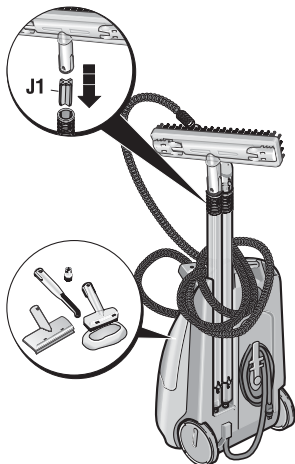

## 4. Information on usage

### 4.1 Cleaning textiles

Before you use the steam cleaner on textiles including delicate fabrics like Dralon, velvet, leather and items protected by Scotch Guard or any similar substance, you should always test that the material is resistant to steam by applying it to a section not normally visible. Apply steam to the concealed section and then leave it to dry. Check to see that the colour and shape have not been affected before moving to a visible area. In case of doubt it is always better to consult your steam cleaner dealer. Use only the steam gun without attachments to apply steam from 30- 45 cm on these delicate fabrics, then wipe off with a cotton cloth.

### 4.2 Cleaning hard surfaces

**!** Do not direct steam onto glued edges of objects, otherwise the edge strip could become detached. Do not use the steam cleaner on wood or parquet floors that have not been sealed.

Some surfaces can change colour and texture when treated with steam. Consult the manufacturers recommendations first, and always test in a non visible place and then let it dry, to see whether changes in colour or textures occur. In case of doubt and on sensitive materials like coated or painted surfaces, wood, waxed marble etc. it is always better to ask your steam cleaner dealer for advice.

If steam is applied for too long, wax, furniture polish, plastic coating or paint could be lifted off or marks could be caused. You should therefore clean these types of surface with a separate cloth to which steam has been applied or very briefly with a double layer of cloth attached to the nozzle.

### 4.3 Cleaning glass surfaces

**!** Do not apply steam jet directly to the sealed parts of the window round the frame, otherwise the seal could be damaged.

When the outside temperature is low, especially in winter, warm the window pane by applying a small amount of steam across the whole surface of the glass. This will even out any differences in temperature and avoid stresses in the glass. This is important because glass surfaces that are heated by varying amounts can shatter.



## 5. How to use the accessories

### 5.1 Steam gun (C1)

The steam gun can be used without any additional accessories.

#### Typical applications:

- eliminating odours and creases in clothing:  
hang the item of clothing up and apply steam from a distance of 10–20 cm.
- removing dust from plants:  
maintain a distance of 20–40 cm.
- dusting objects with a damp cloth:  
apply a small amount of steam to a cloth and wipe over the furniture.

### 5.2 Spot nozzle (E1)

The closer you hold the nozzle to the object being cleaned, the easier it is to remove the dirt. Temperature and pressure are at their greatest immediately the steam is discharged from the nozzle.

#### Typical applications:

- locations that are difficult to access, such as corners and joints
- taps, drains  
wash-basins, WC, shower cabins
- blinds, radiators
- stainless steel, enamel surfaces
- dissolve stains  
Apply vinegar to stubborn stains caused by scale and leave it to soak for approx. 5 min.

### 5.3 Floor nozzle (G1)

- Attach the floor cloth (G3) to the floor nozzle (G1). Fold the cloth lengthways and place the floor nozzle on top. Pull the ends of the cloth one after the other under the retaining clips (G2).

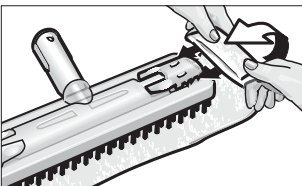

- To remove the cloth, press down on the retaining clips and pull it out.
- Turn the floor cloth over or replace it regularly. This will enable you to wipe up more dirt.
- Work on heavily soiled areas at a slower speed so that the steam has more time to act on the dirt.

- If there are traces of detergent or polish on the surface that you are cleaning (e.g. wax, liquid polish, etc.), this could result in streaks. As a rule these streaks disappear after the steam cleaner has been used several times.

#### Typical applications:

- all washable wall and floor coverings, e.g. stone floors, tiles and PVC floors.

### 5.4 Hand nozzle (F1)

Pull the terry-towelling slip-on (F2) over the hand nozzle (F1).

#### Typical applications:

- smaller, washable areas, such as kitchen surfaces made from plastic, tiled walls
- windows, mirrors
- furniture fabrics
- vehicle interiors, windscreens
- bath-tubs

### 5.5 Window nozzle (H1)

- Before you clean a glass surface with the window nozzle for the first time, go over it with the hand nozzle (F1) and terry-towelling slip-on (F2) to remove any traces of grease.
- Apply steam evenly to the glass surface from a distance of approx. 20 cm. When you have done this, push the locking mechanism on the steam gun towards the rear (child lock) (C4) so that the steam switch (C3) cannot be pressed inadvertently. Squeegee the glass surface in straight lines from top to bottom. Wipe the rubber lip and the bottom edge of the window dry after each pass.

#### Typical applications:

- windows
- mirrors
- other glass surfaces

## 5. How to use the accessories

### 5.5 Household iron



The household iron is available as a special accessory - see page 12

- Firmly insert the modular accessory plug on the iron connecting cable into the socket (A1) above the handle on the main unit. Both lugs on the plug must lock into the cover for the main unit socket (A1).

#### **Steam-ironing:**

- We recommend that you use the Kärcher Ironing Board with active steam extraction. The ironing board has been designed to match your new cleaner and it makes ironing considerably easier and faster to do. In any case, you should use an ironing board which is covered with a mesh-type underlay that enables steam to pass through.
- The temperature control should be set to at least ●● (steam mode) for ironing all types of material. The steam that is then discharged prevents the material from becoming too hot.
- The iron is ready for use as soon as the indicator lamp goes out. The face of the iron must be hot so that the steam does not condense to water and drip onto the item being ironed.
- When you press the switch on the iron, steam is discharged out of holes in the face of the iron. To set the iron so that steam is discharged continuously, push the switch towards the rear until it locks in place. If you briefly push the switch forwards, a shot of steam is discharged from the iron.
- Begin by directing the steam onto a piece of cloth until there is regular flow of steam out of the iron.
- The iron can be held upright to apply steam to curtains, dresses, etc.

#### **Dry-ironing:**

- If you wish to iron without using steam, switch the heater switch to OFF. The steam supply switch must remain ON.
- Set the temperature control according to the type of fabric that you are going to iron. The symbols on the control have the following meanings:
  - Synthetic fibres: ●
  - Wool: ●●
  - Linen: ●●●

### 5.7 Wallpaper remover



The wallpaper remover is available as a special accessory - see page 12

- Place the entire face of the wallpaper remover along the edge of a sheet of wallpaper. Switch on the steam supply (C3) and allow the steam to penetrate the wallpaper until it is soaked through (approx. 10 seconds).
- Move the wallpaper remover to the next section to be removed, keeping the steam switch (C3) pressed. Use a putty knife to lift the loosened wallpaper and pull it off the wall. Move the wallpaper across the wall a section at a time and pull the paper off in strips.
- The steam may not be able to readily penetrate woodchip wallpaper that has been painted over several times. In this case we recommend that you go over the wallpaper with a spiked roller before steam is applied.

### 5.8 Steam-rotary nozzle



The rotary nozzle is available as a special accessory - see page 12

- The rotary nozzle can be attached directly or with the extension tubes to the steam handgun, as required.
- Use the rotary nozzle for loosening stubborn dirt over large areas.

## 6. Maintenance

### 6.1 Cleaning the boiler

**Note:** If you always use demineralised or distilled water, it will not be necessary to clean the boiler.

#### **Rinsing out the boiler:**

Rinse out the steam generator at most after every 5th fill-up if the hardness of water proves to be more than 1.8 mmol/l (corresponds to 10° dH). You can enquire about the hardness of water in your area from your water supply company or municipal public works.

- Fill the boiler with water and shake the cleaner vigorously. This will loosen any scale that has settled at the bottom of the boiler. Tilt the cleaner towards the corner with the funnel inlet (A3) and pour out the water.

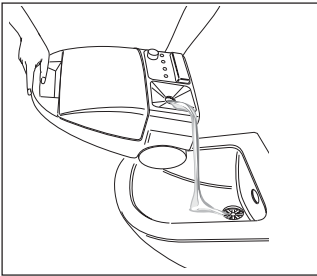

#### **Descaling the boiler:**

As scale also builds up on the walls of the boiler, we recommend that you descale your steam cleaner at the following intervals.

Remove lime-scale deposits after the given number of tank fillings (TF).

TF	Degree of hardness	° dH	mmol/l
100	I soft	0–7	0–1.3
90	II medium	7–14	1.3–2.5
75	III hard	14–21	2.5–3.8
50	IV very hard	> 21	> 3.8

- Unplug the cleaner from the mains electricity supply before you descale the boiler.
- Make sure that all traces of water are drained from the boiler.
- We recommend you use Kärcher Biological Decalcifier RM 511 to descale the boiler. This biological decalcifying agent is based on citric acid and is therefore entirely biologically degradable.

**!** In order to avoid damage to the cleaner, only use products that have been approved by Kärcher.

- Fully dissolve the contents of one bag of Kärcher Biological Decalcifier RM 511 in one litre of warm water.
- Pour this solution into the boiler and leave it to react for approx. 8 hours.

**!** Do not screw the safety cap (A2) onto the cleaner while you are descaling the boiler. Do not use the cleaner if there is any descaling liquid left inside the boiler.

- After the period of soaking, pour the descaling solution out of the boiler. A small amount will remain inside, therefore you should flush the boiler out with cold water two or three times in order to remove all traces of the decalcifying agent.
- The steam cleaner is now ready for use again.

### 6.2 Care of accessories

- Allow all accessories to dry out thoroughly before you store them for use another time.
- Do not stand the floor nozzle (G1), hand nozzle (F1) and circular brush (E1) on their bristles while they are cooling down and drying out, otherwise they could become deformed.
- Floor cloth and terry-towelling slip-on have been pre-washed and can be used immediately with the steam cleaner.
- Dirty floor cloths and terry-towelling slip-ons can be placed in a washing machine at 60 °C and dried in a tumble dryer. Do not use a liquid softener as this would impair the ability of the cloths to pick up dirt.

### 6.3 What to do if a problem occurs

- If a problem occurs with your steam cleaner, contact your local Kärcher service agent (see address list on backside).

## 7. Safety devices

This steam cleaner is equipped with several safety devices which provide multiple levels of safety. The most important safety devices are described below.

### 7.1 Pressure controller

The pressure controller maintains the level of pressure inside the boiler as constant as possible. When the maximum operating pressure inside the boiler of 3.2 bar is reached, the heater is switched off. When steam is drawn off and the pressure drops, the heater is switched on again.

### 7.2 Low-water thermostat

As the water in the boiler is used up, the temperature of the heater increases. The low-water thermostat switches the heater off and the red low-water warning lamp illuminates. The heater is prevented from switching on again until the boiler has either cooled down or has been refilled with water.

### 7.3 Safety thermostat

If the low-water thermostat fails and the cleaner overheats, the safety thermostat will switch off the cleaner. Contact your local Kärcher service agent so that the safety thermostat can be reset.

### 7.4 Safety cap

The safety cap seals in the steam pressure as it builds up inside the boiler. If the pressure controller is defective and the steam pressure inside the boiler rises above 5.7 bar, an over-pressure valve opens inside the safety cap and steam is discharged into the open. Contact your local Kärcher service agent before you attempt to use the cleaner again.

## 8. General information

### 8.1 Warranty

The applicable warranty conditions in different countries are issued by the respective national distributor of KÄRCHER products. During the warranty period, any malfunctions of the unit caused by a material or manufacturing defect will be repaired free of charge.

In the event of a warranty claim, please take the cleaner and accessories, with proof of purchase, to your original dealer or to the nearest authorised customer service centre. We will not be liable for damages occurring as a consequence of improper handling of the cleaner or of failure to observe the information contained in the operating instructions.

### 8.2 Disposal information

This appliance has been manufactured in accordance with VDI Directive 2243 concerning recycling. When the cleaner is no longer required for use, the materials used in its manufacture can be recovered for re-use.

## 9. Accessories and replacement parts

Only accessories and replacement parts approved by the manufacturer may be used with this cleaner. Original accessories and original replacement parts guarantee that the cleaner remains safe and reliable to operate.

On the last page of these operating instructions there is a picture of the cleaner with the order numbers for the individual parts.

<b>Special accessories</b>	<b>Order no.</b>
<b>Rotary nozzle</b>	2.863-094
<b>Household iron</b>	4.862-060
<b>Squeegee strip</b>	6.273-140
<b>Wallpaper remover</b>	2.863-062
<b>Circular brush set:</b> (4 pcs.) for spot nozzle	2.863-058
<b>Circular brass-wire brush set:</b> (3 pcs.) for spot nozzle: with brass-wire bristles for removing particularly stubborn dirt	2.863-061
<b>Cloth set I:</b> 2 large wiping cloths, 3 terry-towelling slip-ons	6.960-019
<b>Cloth set II:</b> 5 terry-towelling slip-ons	6.370-990
<b>Cloth set III:</b> 3 large wiping cloth	6.369-357
<b>Microfibre cloth set:</b> 1 large wiping cloth, 1 terry- towelling slip-on that are highly absorbent and able to pick up large amounts of dirt	6.905-921
<b>Biological decalcifier RM 511:</b> 3 bags of 100 g each	6.290-239

## 10. Technical specifications

Voltage .....	220-240	V
Type of current .....	single phase, 50	Hz
Voltage in hand-gun .....	24	V
Heater power consumption .....	2250	W
Max. operating pressure .....	3.2	bar
Permissible operating pressure .....	5.7	bar
Heating time (per litre of water) .....	approx. 4.5	min
Max. steam volume .....	82	g /min
Weight without accessories .....	5.5	kg
Max. water capacity .....	2.0	l
Boiler capacity .....	2.4	l
Width .....	305	mm
Length .....	480	mm
Height .....	265	mm

### 10.1 Circuit diagram

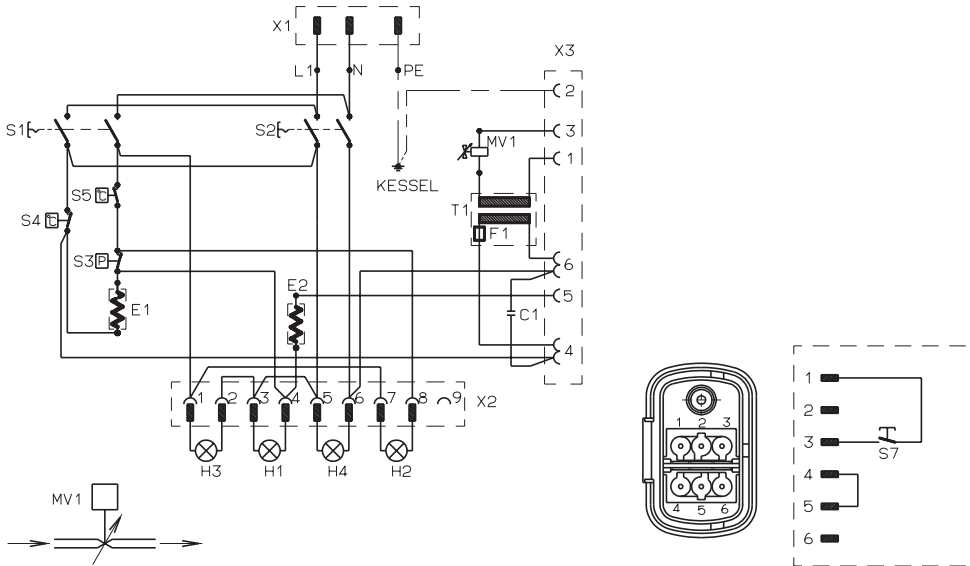

- |                                  |                                   |
|----------------------------------|-----------------------------------|
| S1 Heater switch                 | H2 Indicator lamp – low-water     |
| S2 Steam supply switch           | H3 Indicator lamp – heater switch |
| S3 Pressure switch               | H4 Indicator lamp – steam supply  |
| S4 Safety thermostat             | E1 Heating element 1500 W         |
| S5 Low-water thermostat          | E2 Heating element 750 W          |
| S7 Steam switch – steam gun      | MV1 Solenoid valve                |
| S8 Steam switch – household iron | T1 Transformer                    |
| H1 Indicator lamp – heater       | F1 Fuse                           |

# 11. Spare Parts List

**KÄRCHER 1405**

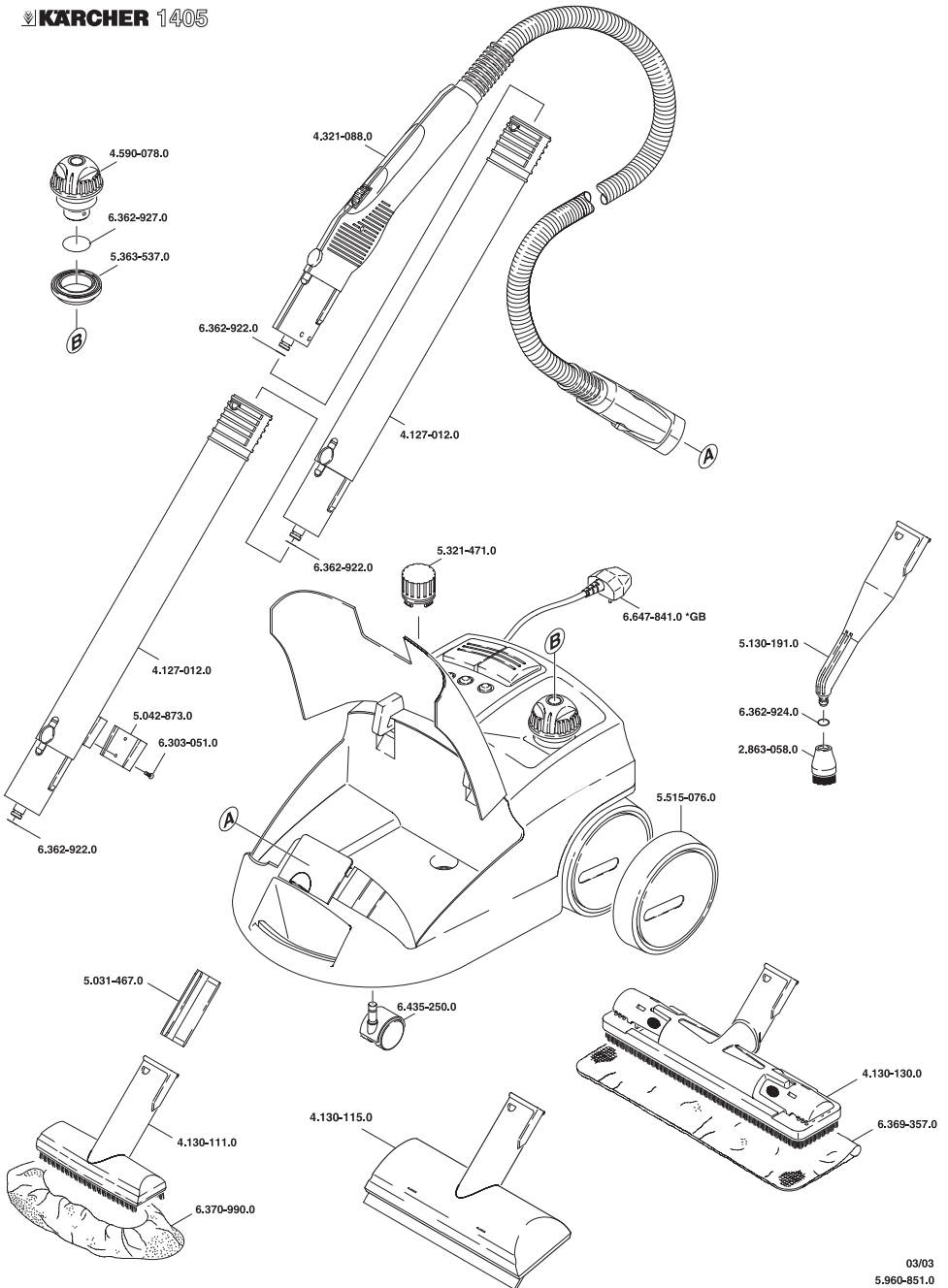

03/03  
5.960-851.0

## EU Declaration of Conformity

We hereby declare that the equipment described below conforms to the relevant fundamental safety and health requirements of the appropriate EU Directives, both in its basic design and construction as well as in the version marketed by us. This declaration will cease to be valid if any modifications are made to the machine without our express approval.

Product: **Steam cleaner**

Model: **1.058-xxx**

### Relevant EU Directives:

EU Low-Voltage Equipment Directive (73/23/EEC) amended by 93/68/EEC.

EU Machinery Directive (89/392/EEC) amended by 91/368/EEC, 93/44/EEC, 93/68/EEC.

EU Directive on Electromagnetic Compatibility (98/37/EEC).

### Harmonised standards applied:

DIN EN 55014-1:2000+A1:2001

DIN EN 55014-2:1997

DIN EN 60335-1

DIN EN 60335-2-79

DIN EN 61000-3-2:2000

DIN EN 61000-3-3:1995+A1:2001

### National standards applied:

TRD 801

Appropriate internal measures have been taken to ensure that series-production units conform at all times to the requirements of current EU Directives and relevant standards. The signatories are empowered to represent and act on behalf of the company management.

Alfred Kärcher GmbH & Co.  
Cleaning Systems  
Alfred-Kärcher-Str. 28-40  
P.O. Box 160  
D-71349 Winnenden

  
H. Jenner

  
S. Reiser

Kärcher (U.K.) Ltd.  
Kärcher House, Beaumont Road  
Banbury Oxon, OX16 1TB  
☎ 01 295 - 752 000; 09 066 800 632



**KÄRCHER**

[www.karcher.com](http://www.karcher.com)